

Alvin Community College

Associate Degree Nursing LVN-to-ADN Transition



Program Information and Application Instructions

Application Period May 12 – June 16, 2025

Classes begin August 2025

(Revised 5/9/2025)

ASSOCIATE DEGREE NURSING

LVN - ADN TRANSITION PROGRAM

APPLICATION PROCEDURE

Gain Admission to Alvin Community College

- ☐ U.S. CITIZENS start here:
<http://www.alvincollege.edu/admissions/getting-started-first-time-students.html>
- ☐ INTERNATIONAL STUDENTS start here:
<https://www.alvincollege.edu/international-students/index.html>
(F1/I-20 students must complete the international student application process by the posted deadline to be eligible for an acceptance offer)

Apply to Nursing

- ☐ Apply at the ADN web page:
<https://www.alvincollege.edu/adn/application.html>
during the application period. Typically, March for Fall start and September for Spring start for 2-year programs and February for Summer start for the LVN-ADN Transition program. See [ADN web page](#) for exact dates.
- ☐ Submit official transcripts from ALL previously attended colleges to the ACC Registrar (electronic preferred).
- ☐ Meet Texas Success Initiative (TSI) standards
- ☐ Meet with a [Health Science Pathways Advisor](#) (All new students who have never attended college must meet with a Pathways Advisor to discuss their certificate or degree plan, test results, course selection, and any other academic advising questions. Returning ACC and transfer students are encouraged but not required to meet with a Pathways Advisor.)
- ☐ Have the [ACC Registrar's Office](#) review out-of-state courses or any courses that are not direct equivalents to the prerequisite courses or ADN curriculum courses (ENGL 1301, PSYC 2301, PSYC 2314, BIOL 2401, BIOL 2402, BIOL 2420, or the core 40/50 elective requirement). Before the application period deadline, email the Registrar's Office requesting course articulation for ADN curriculum courses. Foreign transcripts must be accompanied by an official evaluation from an [approved agency](#).
- ☐ Attend an Applicant Meeting
(meeting schedule is on the [ADN web page](#))
- ☐ Hepatitis-B: Submit proof of the first two Hep-B immunizations or the first "HepIsav" immunization, or submit a copy of a Hep-B surface antibody titer report showing immunity. Titers must be within five years of the nursing application period deadline.
- ☐ Take the HESI A2 exam within 5 years of nursing application deadline. Minimum scores: 78 on reading section, 78 for cumulative score. [Order HESI transcript](#) to be sent to Nursing@alvincollege.edu.

- ☐ Have grades of "C" or better, or be in-progress taking, these prerequisite courses:
 - ENGL 1301 – Composition I
 - PSYC 2301 – General Psychology
 - PSYC 2314 – Lifespan Growth & Development
 - BIOL 2401 – Anatomy & Physiology I (5-year expiration)
 - BIOL 2402 – Anatomy & Physiology II (5-year expiration)
 - BIOL 2420 – Microbiology for Non-Science Majors
- ☐ A 3-credit elective in Language, Philosophy & Culture or Creative Arts is required for graduation and may be completed either during the program or before enrolling in the program, but is not needed to apply (see list of allowed electives in the instructions packet).

What's Next?

Approximately six (6) weeks after the nursing application deadline, we will email you whether you are conditionally accepted, or on the alternate list, or neither of these.

If Accepted?

Nursing admission is conditional, based on completing the following:

- ☐ Attend an orientation meeting
- ☐ Pass a drug screen
- ☐ Pass two background checks: one done for the Texas Board of Nursing and another done by Viewpoint
- ☐ Submit copy of Social Security card if Viewpoint is unable to verify your social security number
- ☐ Submit copy of Physical Examination report
- ☐ Submit copies of Tests, Titers, Immunization series: Tuberculosis test, Hepatitis-B, MMR, adult Tdap, Varicella, and Seasonal Influenza
- ☐ Submit copy of Driver's License or another official picture ID
- ☐ Submit copy of current CPR card
- ☐ LVN-ADN Transition students are required to submit proof of health insurance and a Hepatitis-B titer report before beginning the nursing program.

For details on each of the above steps: go to
www.alvincollege.edu/adn

Questions? email nursing@alvincollege.edu or call
281-756-5630

Admission steps are subject to change at any time. Please go to the ADN web page for the most up-to-date information.

Alvin Community College is an Equal Opportunity Institution: If you require special accommodations for a disability, contact the Office of Student Accessibility Services at 281.756.3533 or mailto:sas@alvincollege.edu.



We're glad you're interested in the Alvin Community College (ACC) LVN-ADN Transition program! ACC has educated individuals to enter the nursing profession for over 50 years and has a reputation of an outstanding ADN program. We will accept applications **May 12 - June 16, 2025** for the LVN-ADN Transition program that starts August 2025.

To be considered for the LVN-ADN Transition program, applicants must meet admission requirements in the College Catalog and complete the application steps below. The ADN department must receive the application and required supporting documents **no later than 4 pm June 16, 2025!**

Approximately six (6) weeks after the application deadline, we will email you whether you are conditionally accepted, on the alternate list, or neither of these. Keep your email address(es) current with the ADN department and make sure Alvin Community College emails go to your inbox rather than your junk or spam folder. Email is the official means of communication from ACC to students.

STEPS FOR APPLYING

MINIMUM REQUIREMENTS

- Please use the checklist on the first page of this packet to assist in keeping track of what steps you have done and what steps remain to be done.
- You must meet the following minimum requirements by the nursing application deadline to be eligible to apply to the nursing program. If you do not meet these minimum requirements your application will not be considered.
- **GPA = 3.0 or higher:** If at the time you apply, you have grades in any courses that are part of our ADN degree, the GPA of those grades must be at least 3.0. Courses in-progress at the time you apply do NOT count in the GPA. Grades posted after the deadline will NOT count in the GPA. Grades that are not part of the ADN degree will NOT count in the GPA. See "How do I calculate my GPA" in the Frequently Asked Questions at the end of this document to find out whether your GPA is high enough.
- **HESI A2 test scores = 78 or higher:** You must make at least 78 for both the reading section and cumulative score. You can make less on other sections (except for reading) as long as the cumulative score is at least 78. See the "TAKE THE HESI A-2 TEST" in this packet for more details.
- Complete the steps below **by the nursing application deadline.**

1. GAIN ADMISSION TO ALVIN COMMUNITY COLLEGE:

U.S. CITIZENS: <https://www.alvincollege.edu/admissions/getting-started-first-time-students.html>

INTERNATIONAL STUDENTS: <https://www.alvincollege.edu/international-students/index.html>

- You must be admitted to ACC before you can apply to the ADN program.
- If it has been a year or more since you last applied to ACC or took courses at ACC, you may need to re-apply to ACC and have your transcripts re-sent. Check with the Admissions Office if you are unsure: 281-756-3531.
- You must meet all college admissions requirements, in addition to all nursing requirements, in order to be eligible to enroll in nursing programs. Please refer to the College Catalog and work with the Admissions Office to be sure you meet all college admission requirements.

2. APPLY TO NURSING at [Application](#)

- You must be admitted to ACC before you can apply to the ADN program.
- Click the "Apply Here" button on the [ADN application page](#) to complete your nursing application. Login to your ACC ConexED account or create a Guest Account. You may need to create the Guest Account then return to the nursing application. **You will receive a "form successfully submitted" email at the email**

address linked with your ConexED login. A second email will be sent after your application is reviewed by the nursing department. If you do not receive these emails, your application was **not** successfully submitted. Neither of those emails means you were admitted to the program. They only indicate that your application form was submitted. If you do not receive confirmation of successful application submission, contact the nursing program or re-submit the application after verifying all fields are complete **before the application deadline**.

- Check your milestones on your [ConexED dashboard](#) to verify items were received or steps completed. You may also submit milestone completion requests to verify completion of steps. Milestone completion requests will be processed weekly. You can also view your submitted application or upload additional documents in your ConexED dashboard. **It is your responsibility to verify transcripts have been received or steps completed before the end of the application period.**
- If you have issues or questions about the ADN application, please contact the nursing department.
- Anyone who previously applied, must submit a new application for the August 2025 Transition program.

3. SUBMIT OFFICIAL COLLEGE TRANSCRIPTS to the ACC Registrar

- Have all previously attended U.S. colleges and/or universities send official transcripts to the ACC Registrar. **DO NOT** bring or send college transcripts to the nursing department or the applicant meeting! These go to the registrar.
- Students with credits or degrees from foreign institutions must have foreign transcripts evaluated by an approved evaluation company and submit the official report to the ACC registrar. Approved evaluation companies are in the ACC College Catalog under the heading "Evaluation of Credit from Foreign Institutions"

4. HAVE THE ACC REGISTRAR'S OFFICE AND/OR YOUR HEALTH PATHWAYS ADVISOR REVIEW OUT-OF-STATE COURSES OR ANY COURSES THAT ARE NOT DIRECT EQUIVALENTS TO THE ADN CURRICULUM COURSES:

- Nursing applicants with any out-of-state or international transcripts must email the ACC Registrar's Office to request articulation of those courses. If any courses taken in the state of Texas are not directly equivalent to ADN courses (for example, Anatomy and Physiology taken as separate courses or substituting a higher-level course for an ADN course), the course must be reviewed by the Registrar's Office to determine articulation. After submitting official college transcripts reflecting the courses, email registraroffice@alvincollege.edu to request articulation of ADN curriculum courses for your ACC nursing application. If the course does not articulate, you should meet with an ACC [Health Science Pathways Advisor](#) to determine if a course substitution would be permitted. The deadline to request articulation or to meet with a Pathways Advisor to inquire about course substitution, if needed, is the end of the nursing application period.
- Foreign transcripts must be accompanied by an official evaluation from an approved agency, which are listed in the college catalog and on the college web site at:
www.alvincollege.edu/international-students/foreign-transcripts-evaluation-agencies.html
- Any course substitutions are unofficial until approval by the subject area Department Chair has been completed.

5. MEET TEXAS SUCCESS INITIATIVE (TSI) STANDARDS

- TSI is a Texas law requiring college students to achieve minimum standards in Reading, Writing, and Math.
- Prior college transcripts showing TSI standards met should fulfil the requirement when submitted to the registrar.
- See the [Testing Center](#) page for information on meeting TSI requirements.
- If you have not attended any Texas colleges, call the ACC Admissions Office 281-756-3531 to find out how to meet TSI standards.

6. ATTEND A MANDATORY APPLICANT MEETING (schedule on next page).

- Applicant meetings are held on-line and in-person during the application period. The link to on-line meetings is on the [Applicant Meetings](#) web page.
- Select the correct meeting. Log into on-line meetings PROMPTLY.
- Attendance will be taken during meetings.

- In-person meetings are conducted in Room S105 of the Health Science Building (S Building) at Alvin Community College (see maps at the end of the packet for directions to the location).
- All applicants must attend a May/June 2025 LVN-ADN Transition applicant meeting. The meeting schedule is on page 4. *If you attended a Feb. 2025 meeting, you are not required to attend another this cycle.*
- General information meetings or other nursing program meetings do not substitute for the applicant meeting.

7. SUBMIT HEPATITIS B VACCINATION OR IMMUNITY PROOF

- Submit proof of Hepatitis B vaccination or immunity with your nursing application. Upload the documentation with your application. One of the following is required: 1) a record showing the dates of at least the first two Hep B injections in the conventional vaccination series; 2) proof of the first shot of the two-shot *Heplisav* brand vaccination (document must state that brand); **OR** 3) report of Hepatitis B *immunity* (a Hepatitis B surface antibody titer).
- There is no time limit on the age of Hep B injections; there is a 5-year time limit on the Hep B titer. Childhood vaccination records are acceptable.
- The Hep B titer is accurate only if it is done at least two months after the third Hep B shot.
- The correct documentation must be submitted by the nursing application deadline.

8. TAKE THE HESI A2 TEST

either before or after the applicant meeting; official test scores must reach us by the end of the application period (see "HESI A2TEST INFORMATION" for details)

- We use only the HESI A2 test for nursing admission. You cannot substitute any other test. A high enough HESI A2 test score, by the nursing application deadline, is mandatory for all ADN applicants regardless of educational background or college degrees you may already have - no exceptions.
- You must take these 5 HESI sections: Reading Comprehension, Grammar, Vocabulary & Knowledge, Anatomy & Physiology, and Math. You must make at least 78 on both reading and cumulative of the above five sections.
- HESI test scores must be 5 years old or less as of the nursing application deadline.
- See "HESI A2 TEST INFORMATION" later in these instructions for more details, including **wait period between re-tests and submitting official transcripts**.

9. PREREQUISITE COURSES

- Already have grades of "C" or better, or be in-progress taking these prerequisite courses:
 - ENGL 1301 - Composition I
 - PSYC 2301 - General Psychology
 - PSYC 2314 - Lifespan, Growth & Development
 - BIOL 2401 - Anatomy & Physiology I (Must be within 5 years of the application period deadline.)
 - BIOL 2402 - Anatomy & Physiology II (Must be within 5 years of the application period deadline.)
 - BIOL 2420 – Microbiology
 - **GPA of the courses must be 3.0 or higher.**

10. OTHER COURSES

- A 3-credit elective in Language, Philosophy & Culture or Creative Arts is required for graduation and may be completed either during the program or before enrolling in the program, but is not needed to apply (see the list of allowed elective courses at the end of these application instructions)
- If you already have elective grade(s) by the nursing application deadline, we will use the highest grade when ranking your nursing application.

11. AN APPLICANT IS INELIGIBLE IF:

- GPA in nursing curriculum general education classes is less than 3.0 (GPA is not rounded up)
- HESI Reading Comprehension score is less than 78
- HESI Cumulative score is less than 78 (Average of the Reading, Math, Vocabulary & General Knowledge, Grammar, and Anatomy & Physiology sections)

- More than one D or F in any nursing courses (RNSG, VNSG, or BSN courses) or biology courses (BIOL 2401, 2402, 2420 or the equivalent) within the past five years of the application deadline (Note: If the nursing course grades were prior to completion of the VNSG program, those are not considered. D/F grades during the VNSG program are considered if within the past five years.)
- Dismissal for unprofessional or unethical behavior from another allied health program
- Has a felony conviction, deferred adjudication felony, or on parole for a felony

MANDATORY APPLICANT MEETINGS FOR LVN-ADN TRANSITION PROGRAM, AUGUST 2025 ADMISSION

Applicants must attend one meeting from the schedule below. Registration for meetings is not required. Attendance at a "general information meeting" does not substitute for the applicant meeting. Applicants must still attend one of the meetings below. If you attended a February, 2025 meeting, you are not required to attend another this cycle.

Meetings start promptly at the times below.

On-line meetings: Go to the [ADN meeting web page](#) and click the ***LVN-ADN Transition Applicant Meeting*** link to join the meeting a few minutes before the scheduled time.

APPLICANT MEETING SCHEDULE

Time	Date	Location
2 pm	05/20/2025	On-line
2 pm	05/27/2025	On-line
11 am	06/16/2025	On-line

(All dates/times subject to change. Any changes will be posted on the web page.)

All required documentation is due by 6-16-2025 by 4pm including:

- 1) Official transcripts from all colleges attended submitted to the Registrar.
- 2) Meet all TSI requirements.
- 3) HESI A2 scores submitted to the ADN office (exception: tests taken by the above deadline at ACC; we will wait for the scores to come in even if it is after the deadline)
- 4) Proof of either the first two Hep B shots or Hep B immunity submitted to the ADN office. If "heplisav" shot, proof of only one shot is needed by the deadline.
- 5) Attend one of the above applicant meetings. (Attending a general information meeting does not count.)
- 6) Submit an on-line application to the LVN-ADN Transition program at the ADN web page.

Completed Applications: Those who complete all ADN application steps by the nursing application deadline and meet minimum admission criteria are considered for admission. Being eligible for consideration does not guarantee an offer of admission. **It is your responsibility to verify steps were completed by checking your milestone completion status in your ConexED dashboard.** Make sure you have completed all ADN application steps by the deadline. **Only complete applications will be considered. Your application is *not* complete unless all of the above steps are completed and the nursing application submitted by the deadline.** You may contact the ADN office at nursing@alvincollege.edu or 281-756-5630. Email is the official means of communication between ACC and students or applicants!

Selection for Admission: Admission is competitive. After the application deadline, applicants are ranked primarily according to number of completed courses in the ADN curriculum, the GPA of those courses, and HESI A2 test scores. Priority admission is given to applicants who: 1) achieve high HESI A2 test scores and 2) have a high GPA in ADN curriculum courses. Additional consideration is given to applicants who: 1) complete ADN curriculum courses without repeating or withdrawing from courses within five years of the application deadline; 2) complete BIOL 2401/2402/2420 at ACC; 3) hold a Bachelor's or higher degree from an accredited college or university; and 4) reside in the ACC tax district.

Program Requirements: Program requirements are discussed during applicant meetings and published in the ACC College Catalog. After initial acceptance and as a condition for final acceptance, applicants must pass two criminal background checks and a drug screen. Applicants who answer "Yes" to any eligibility questions on the "Background Checks" page of this packet must submit the BON outcome letter, or declaratory order if one is required by the BON, to the ADN department no later than 30 days before start of class. All applicants who are accepted must complete a physical exam and submit proof of completing all required tests and immunizations, including completing the Hepatitis B vaccination series or proof of immunity, by first day of class. All LVN-ADN Transition students must submit a Hepatitis B surface antibody immunity titer from within the past five years and proof of health insurance by the first day of class.

HESI A2 TEST INFORMATION

- Health Education Systems, Inc. (HESI) is a company that produces tests which evaluate whether nursing applicants have the knowledge and skills to be successful in nursing school.
- Alvin Community College nursing programs require applicants to make a high enough score on the HESI Admission Assessment Exam (HESI A2 test) in order to be considered for admission. An acceptable HESI A2 test score is mandatory for all nursing applicants regardless of educational background, no exceptions. You may not substitute any other test scores for HESI test scores.

HESI A2 DATES & REGISTRATION

- Register for HESI A2 at ACC – go to www.alvincollege.edu, click on “Marketplace” at the top of the screen, click on “Testing Center” in the red box near the bottom of the screen, then click on the “HESI” icon for open test dates and instructions for registering for HESI A2. The test date you select **MUST BE ON OR BEFORE THE NURSING APPLICATION DEADLINE**. Test dates are usually released near the end of a month for the following month.
- HESI A2 test dates at ACC - If you don't see a test date in the time range that you want at the above web page, either those dates are already full, or dates in that time range have not been opened yet. You will have to check back later to see if desired dates show up on the web page or contact the Testing Center at 281-756-3526 or Assessment@alvincollege.edu.
- HESI A2 at other locations - Applicants who are unable to take the HESI A2 exam at ACC may either try to find another testing location or contact the ACC Testing Center to receive information on the Prometric Center testing option and arrange an exam.

HESI A2 DEADLINE

- If you take the HESI A2 at ACC, the deadline to take it is the nursing application deadline. The nursing office automatically gets your scores within 2 days after you take the test. If you take the test at ACC on the deadline or close to the deadline, it is OK if your scores come back after the deadline.
- If you take the HESI A2 elsewhere, THE SCORE REPORT MUST REACH THE NURSING OFFICE BY THE NURSING APPLICATION DEADLINE. It could take the HESI company two weeks or longer to send the report, so make sure you take the HESI early enough that the report has time to reach the nursing office by the deadline. HESI TESTS TAKEN AT LOCATIONS OTHER THAN ACC ARRIVING AFTER THE NURSING APPLICATION DEADLINE WILL NOT BE ACCEPTED.

HESI A2 TEST SCORE CRITERIA

- You must take all of these five sections of the HESI A2 test:
Math, Reading Comprehension, Vocabulary & General Knowledge, Grammar, and Anatomy & Physiology.
- Minimum required scores:
(1) at least 78 on the Reading Comprehension section; and
(2) at least 78 for the Cumulative score, which is the average of the above section scores.
These minimums are ABSOLUTE CUTOFFS – we do NOT round up scores to meet these minimums.
- The nursing department does not count any other sections and does not count the Critical Thinking test.
- Section scores may be combined from two or more tests subject to the waiting period for any re-takes of individual sections described under "Re-Taking the HESI A2".
- Scores must be from HESI A2 tests taken no more than 5 years ago as of the nursing application deadline; otherwise the scores are too old, and you will have to re-take those sections.

RE-TAKING THE HESI A2

- **Tests taken prior to January 2022**, a minimum of 30 days must have elapsed between re-test attempts.
- **Tests taken prior to January 2022**, HESI sections re-taken 30 or more days apart: the highest score of all takes of that section will be used when we calculate your cumulative score.
- **Tests taken prior to January 2022**, HESI sections re-taken less than 30 days apart: the earlier section score will be used regardless of which score is the highest.
- **Tests taken January 2022 and after**, two exams from a twelve-month period may be submitted. Each exam submitted must be **90 days** from *any* prior HESI exam section attempt for the new section scores to be considered. More than two exams may be submitted but the exams must be from other twelve-month periods and meet the requirements for time between exams.

- **Tests taken January 2022 and after**, HESI sections retaken 90 or more days apart: the highest score of section takes will be used to calculate the cumulative score. Only two tests for any section may be submitted from a twelve-month period. The tests must be 90 days from any prior section test for the scores to be used. Scores from tests not meeting these requirements will not be considered. Sections taken less than 90 days apart: the earlier section score will be used regardless of which score is the highest.
- All re-takes must comply with the "HESI A2 deadline" and "HESI A2 test score" paragraphs.

COST OF THE HESI A2 TEST

- It costs \$74 (price subject to change without notice) to take the HESI A2 at Alvin Community College regardless of how many sections of the test you take.
- The cost is set by each testing location, so it may cost more or less to take the HESI A2 elsewhere. But if you take the HESI elsewhere, you will have to pay the Evolve company a fee to email an official score report to the ACC nursing department.

GETTING YOUR HESI SCORES TO THE ACC NURSING DEPARTMENT

- If you take the HESI A2 at **ACC**, the nursing department automatically gets your scores 2 days later. **DO NOT PAY TO HAVE ACC SCORE REPORTS SENT** because we will automatically get those.
- If you take the HESI A2 **elsewhere**, you must pay a fee to have the company email the official score report (called a "HESI transcript") to the nursing office at nursing@alvincollege.edu
 - For instructions on how to do this, go here: : https://service.elsevier.com/app/answers/detail/a_id/8093/kw/hesi%20transcript/supporthub/evolve/role/student/
 - It could take two weeks or more for the company to email the score report, so be sure you request the report in time for it to get to the nursing office by the nursing application deadline. Score reports arriving after the nursing deadline will not be accepted.
- **WE DO NOT ACCEPT HESI SCORE REPORTS DIRECTLY FROM NURSING APPLICANTS.**

PREPARING FOR THE HESI A2 TEST

- A good way to prepare for the HESI A2 is to buy a study guide specifically for this exam. One such guide is *HESI Admission Assessment Exam Review, 5th edition*. You can buy this from the ACC book store (<http://www.alvincstore.com>) or online at sites such as Amazon or Barnes & Noble by searching on "HESI A2".
- The study guide will include samples of test questions as well as information regarding test question formats. It will highlight important concepts and provide tips for studying and test-taking.
- There are online tools available through Apple's App Store that some people have found beneficial (such as pocketprep™)
- Alvin Community College does not currently offer any HESI prep courses. You may be able to find prep courses by googling on "HESI A2 prep course". Additional information on the HESI may be found on the following pages and on the ADN web page <https://www.alvincollege.edu/adn/hesi.html>.
- Additional resources are available to ACC students on the [Learning Lab POD](#) page. Scroll down on the lower right for Student Success Skills > scroll and click to expand Other Practice Tests > HESI A2. You must be logged into the ACC POD to access these resources.

OTHER HESI INFORMATION

- To find out if there are additional HESI A2 test dates at ACC, or whether a test date is still open, or details about HESI testing procedures, or payment/cancellation/refund procedures, call the Testing Center 281-756-3526.
- If you have a documented disability and may need accommodations for testing, contact the Student Accessibility Services 281-756-3533 or SAS@alvincollege.edu BEFORE registering for or taking the HESI A2.
- IF YOU INTEND TO USE YOUR HESI SCORES TO APPLY TO MORE THAN ONE NURSING SCHOOL,
 - You need to find out whether the other nursing school requires the HESI to be taken on their campus (some schools will not accept HESI scores taken off-campus).

- If they do require HESI to be taken at their campus, you should take the HESI there and then pay to have an official score report emailed to the ACC nursing office. Then you can use your HESI scores to apply to both ACC and to the other nursing school.
- Note - if the HESI you take at the other college does not include some of the sections we require, you will have to take those sections either at ACC or another school that offers those sections.

HESI A2 EXAM AT A GLANCE

<u>Required for:</u>	<u>Subjects Tested (you can select order):</u>	<u>Number of Questions</u>	<u>Time</u>
<ul style="list-style-type: none"> ★ ADN ★ LVN ★ LVN-ADN Transition ★ Diagnostic Cardiovascular Sonography ★ Respiratory Care 	<ul style="list-style-type: none"> ★ Reading Comprehension ★ Grammar ★ Vocabulary ★ Math (<i>has on screen calculator</i>) ★ Anatomy & Physiology 	55 55 55 55 30	4 ½ HOURS TOTAL (self-paced)

QUALIFYING SCORES

(NOTE: scores will NOT be rounded up)

<u>ADN MINIMUM SCORES:</u>	<u>LVN MINIMUM SCORES:</u>
<ul style="list-style-type: none"> ➤ Reading Comprehension: 78 ➤ Cumulative (Average): 78 	<ul style="list-style-type: none"> ➤ Reading Comprehension: 70 ➤ Cumulative (Average): 65 ➤ BONUS: a MATH score of 85 will increase your ranking

FUTURE PLANNING

<u>CURRENT RETAKE POLICY</u>	<u>CLASSES THAT HELP PREPARE FOR HESI</u>
<ul style="list-style-type: none"> ◆ 2 attempts per year ◆ 90+ day wait in between tests ◆ Scores valid for 5 years 	<ul style="list-style-type: none"> ◆ ENGL 1301 ◆ MATH Courses ◆ BIOL 2401 & 2402 (Anatomy & Physiology)

EVOLVE (www.evolve.elsevier.com)

Sign In --> Create Account --> Student

After registering, you will be assigned a username. Remember this username to test.

TAKING THE TEST

<u>HOW TO REGISTER:</u>	<u>COST:</u>	<u>WHAT TO BRING TO TEST:</u>
ACC Website --> Marketplace --> Testing <i>(availability is only posted for 1 month at a time)</i> ACC Testing Center is located in Building A-152	\$74 <i>price subject to change</i>	<ul style="list-style-type: none"> ✓ Photo ID ✓ Know your assigned Evolve username & password

SUGGESTED RESOURCES

<u>ACC College of Nursing Recommends:</u>	<u>Additional Suggestions:</u>
HESI Admission Assessment Exam Review, 5th Edition (or most recent edition available) ADDITIONAL QUESTIONS? Email: nursing@alvincollege.edu	<ul style="list-style-type: none"> ▪ iTunes apps like pocketprep ▪ 3 Evolve Reach HESI A2 Practice Tests by Kathy Zahler ▪ CliffsNotes Anatomy & Physiology Quick Review by Steven Bassett ▪ Quizlet.com ▪ There are MANY more online resources by googling HESI A2

ACC students: On the [Learning Lab POD](#) page > scroll down on the lower right for Student Success Skills > click to expand Other Practice Tests > HESI A2 for additional study resources.

Nursing Transition (LVN-to-ADN), A.A.S.

(CIP 51.3801)

281-756-5630

Purpose: The transition program is to provide a pathway from Licensed Vocational Nursing (LVN) to Associate Degree Nursing (ADN). The program seeks to prepare graduates who are critical thinkers and competent practitioners. As Associate Degree Nursing graduates, they will practice within the defined roles and competencies of the Associate Degree nurse. In response to community and societal needs, they will be prepared to care for individuals and families in structured settings. Courses are presented according to their content and effectiveness toward successful fulfillment of state board competencies.

Upon successful completion of the program, the graduate is eligible to make application to write the National Council Licensure Examination for Registered Nurses (NCLEX-RN).

Program Requirements: A new class will begin each summer semester. Qualified applicants will be admitted according to space available. To be considered for admission to the Transition pathway of the Associate Degree Nursing Program, the applicant must:

1. Apply to Alvin Community College and fulfill the admission requirements of the college.
2. Apply to the ADN Program during an application period and meet admission and program requirements for that program.
3. Hold an unencumbered license to practice vocational nursing in the State of Texas by the nursing application deadline, or be scheduled to graduate from the ACC/VN program. Current students must take and pass NCLEX-PN prior to enrolling in Fall semester courses.
4. Have recent work experience, preferably in an acute care setting, as a licensed vocational nurse, or:
 - a. scheduled to graduate from the ACC/VN program.
 - b. graduated within one year from a state approved vocational nursing program.
5. Complete prerequisite courses before the start of the nursing program.
6. Have a cumulative GPA of 3.0 or better in nursing and nursing curriculum courses.
7. HESI-A2 exam within 5 years of nursing application deadline. Minimum scores: 78 on reading, 78 for cumulative score.

Selection for Admission: Admission to the LVN-to-ADN program is competitive. After the application deadline, applicants are ranked primarily according to the number of completed courses in the ADN curriculum, the GPA of those courses, and HESI A2 test scores. Priority admission is given to applicants who: 1) achieved high standardized test scores (HESI A2); 2) earned a high grade point average in the ADN curriculum academic coursework; 3) complete ADN curriculum courses without repeating or withdrawing from courses in the last five years from the application deadline; 4) complete ADN curriculum courses at ACC; 5) hold a Bachelor's or higher degree from an accredited college or university; and 6) reside in the ACC tax district. Additional Program details can be found on the "Nursing" Catalog pages.

Prerequisites

- BIOL 2401 - Anatomy and Physiology I 4 Course Credits Δ^+
- BIOL 2402 - Anatomy and Physiology II 4 Course Credits Δ^+
- BIOL 2420 - Microbiology for Non-Science Majors 4 Course Credits Δ
- ENGL 1301 - Composition I 3 Course Credits Δ^+
- PSYC 2301 - General Psychology 3 Course Credits Δ^+
- PSYC 2314 - Lifespan Growth and Development 3 Course Credits Δ^{**}

Semester Credits: 21

First Semester

- RNSG 1240 - Prof Nurs Skills for Articulating Stud 2 Course Credits
- RNSG 1262 - Clinical RN Transition 2 Course Credits
- RNSG 1327 - Transition to Professional Nursing 3 Course Credits

Semester Credits: 7

Credit for Prior Learning

- RNSG 1219 - Integrated Nursing Skills I 2 Course Credits
- RNSG 1523 - Intro to Prof Nur for Integrated Program 5 Course Credits
- RNSG 2504 - Integrated Care - Common Needs 5 Course Credits

Semester Credits: 12

Second Semester

- Select 3 Course Credits from Creative Arts Core Curriculum ^{**+}
or
- Select 3 Course Credits from Language, Philosophy and Culture Core Curriculum ^{**+}
- RNSG 2462 - Clinical III RN 4 Course Credits
- RNSG 2514 - Integrated Care - Complex Needs 5 Course Credits

Semester Credits: 12

Third Semester

- RNSG 2435 - Integrated Care - Management 4 Course Credits
- RNSG 2463 - Clinical-RN IV 4 Course Credits *

Semester Credits: 8

Total Credits Required for A.A.S. Nursing Transition: 60

⁺ Denotes core requirement. Speak with Department Chair or Pathways Advisor for proper course selection.

^{**} May be taken prior to admission to the ADN program.

^{*} Capstone Course

^Δ Field of Study curriculum course

Statutory law (Texas Occupations Code, Chapter 53) requires the Alvin Community College nursing and allied health programs to notify prospective applicants and future healthcare professionals a licensing/credentialing authority may suspend or revoke a license/credential, disqualify a person from receiving a license/credential, or deny to a person the opportunity to take a licensing/credentialing examination on the grounds that the person has been convicted of certain criminal behavior.

Nursing (ADN), A.A.S.

(CIP 51.3801)

281-756-5630

Purpose: The program seeks to prepare graduates who are critical thinkers and competent practitioners. As Associate Degree Nursing (ADN) graduates, they will practice within the defined roles and competencies of the Associate Degree nurse. In response to community and societal needs, they will be prepared to care for individuals and families in structured settings. Courses are presented according to their content and effectiveness toward successful fulfillment of state board competencies.

Upon the successful completion of a minimum of two (2) academic years and all program requirements, the graduate is eligible to make application to write the National Council Licensure Exam for Registered Nurses (NCLEX-RN).

The program is approved by the Texas Board of Nursing (BON) and accredited by the Accreditation Commission for Education in Nursing, Inc. (ACEN). The mission of the BON is to protect and promote the welfare of the people of Texas by ensuring that each person holding a license as a nurse in the State of Texas is competent to practice safely. The ACEN is recognized by the U.S. Department of Education as the national accrediting body for all types of nursing education programs. The Associate Degree nursing program at Alvin Community College located in Alvin, Texas is accredited by the Accreditation Commission for Education in Nursing (ACEN). The most recent accreditation decision made by the ACEN Board of Commissioners for the Associate Degree Nursing program is Continuing Accreditation.

Texas Board of Nursing (BON)
George H.W. Bush State Office Building
1801 Congress Avenue, Suite 10-200
Austin, TX 78701
512-305-7400
<http://www.bon.texas.gov/>

ACEN
3390 Peachtree Road NE, Suite 1400
Atlanta, GA 30326
404-975-5000
<https://www.acenursing.org/>

A person who has been convicted of or received deferred adjudication for anything other than a minor traffic violation, has been diagnosed with mental illness, or has a history of substance abuse, should contact the Texas Board of Nursing for licensure eligibility criteria. Individuals with felonies are ineligible for admission to the ADN Program.

Admission Requirements:

A new class begins each fall and spring semester. Applications are available at www.alvincollege.edu/adn during the application period. Application periods are typically in March and September. Refer to the website for the specific dates of each application period. Qualified applicants are admitted according to space available. To be considered for admission to the Associate Degree Nursing (ADN) Program, the applicant must:

1. Be fully admitted to Alvin Community College.
2. Submit an ADN application to the ADN department during the application period.
3. Submit, by the application deadline, proof to the ADN department of having met the following minimum admission standards:
 - a. HESI A2 test score of 78 or higher on the cumulative and a 78 or higher on the Reading section. The following HESI A2 sections must be taken: Math, Reading Comprehension, Vocabulary and General Knowledge, Grammar, and Anatomy and Physiology. Section scores may be combined from more than one HESI A2 test. All HESI A2 section scores must be less than or equal to 5 years old as of the ADN application deadline. Beginning January 2022, ADN applicants may repeat individual HESI-A2 sections no less than 90 days apart. Students may submit two HESI-A2 exams from a twelve-month period. Each exam submitted must be at least 90 days from any prior HESI exam section attempt for the new section score to be considered. For any HESI-A2 section(s) repeated less than 90 days apart, the earlier section score is counted and the latter section score is not, regardless of which section score is the highest. For any HESI-A2 section(s) repeated 90 or more days apart, not exceeding the maximum of twice a calendar year, the highest section score is counted. For tests taken prior to January 2022, sections may be repeated no

- less than 30 days apart. For any HESI-A2 section(s) repeated less than 30 days apart, the earlier section score is counted and the latter section score is not, regardless of which section score is the highest. This policy applies regardless of the testing location. (The ADN department does not accept HESI A2 score reports from students. HESI A2 score reports are automatically available to the ADN department if the HESI A2 is taken at Alvin Community College. If the HESI A2 is taken elsewhere, the applicant must pay a fee to Elsevier to have the official score report sent to the ADN department.)
- b. TSI (Texas Success Initiative) requirement satisfied as determined by ACC's testing and placement policies. Transfer students must meet the transfer institution's TSI requirements if not enrolled at ACC.
 - c. Cumulative GPA of 3.0 or better in nursing and nursing curriculum courses.
 - d. Receipt of at least two (2) of the three (3) immunizations for Hepatitis B or proof of Hepatitis-B immunity (positive HBsAB) by application deadline. The series of three (3) immunizations must be completed by the start date of the program.
4. Attend one of the mandatory ADN Applicant meetings discussing specific program policies and requirements held during the application period.
 5. Submit to the ACC Registrar's office official transcripts from all colleges/universities attended. No academic course with a grade below C is accepted for transfer credit in the ADN program. Academic courses include composition/written communication, social/behavioral/biological sciences, humanities, and visual/performing arts. Do not submit college transcripts to the nursing office. Applicants with credits from institutions outside the United States must have their foreign transcripts evaluated by one of the approved companies listed in the Evaluation of Credit from Foreign Institutions section of the College Catalog. The ADN department will use the evaluation company's report when assessing the applicant's foreign credits and grades. The applicant must submit the original evaluation report to either the ADN department or the Admissions Office by the nursing application deadline. Any out of state transcript must be evaluated by an advisor at least 45 days prior to the application deadline. Make an appointment at: Advising@alvincollege.edu.
 6. Have completed or be in-progress taking the prerequisite courses of **BIOL 2401**, **BIOL 2402**, **PSYC 2301**, and **ENGL 1301**.
 7. Students are ineligible for admission if at the time of application transcripts reflect more than one (1) D or F in a nursing course or nursing curriculum science course (BIOL 2401, 2402, and 2420) taken within five years of the application deadline. This includes RNSG, VNSG, and BSN courses regardless if the course is in the ACC ADN curriculum. The student is ineligible even if the course is repeated and the student earns an A, B, or C in the subsequent attempt.
 8. A student is ineligible for admission to the ACC nursing program if he/she has been dismissed for unprofessional or unethical conduct while previously enrolled in a health occupation program.

Selection for Admission

Admission to the ADN program is competitive. After the application deadline, applicants are ranked primarily according to the number of completed courses in the ADN curriculum, the GPA of those courses, and HESI A2 test scores. Priority admission is given to applicants who: 1) achieved high standardized test scores (HESI A2) and 2) earned a high GPA in the ADN curriculum academic coursework. Additional consideration is given to applicants who: 1) complete ADN curriculum courses without repeating or withdrawing from courses in the last five years from the application deadline; 2) complete ADN curriculum courses at ACC; 3) completed **BIOL 2420**; 4) hold a current certificate in a health profession (for example, but not limited to: CNA, CMA, EMT, dental assistant, etc.) 5) hold a Bachelor's or higher degree from an accredited college or university; and, 6) reside in the ACC tax district.

Program information:

1. **BIOL 2401** and **BIOL 2402** must be taken within five years of application deadline. BIOL courses completed more than five years prior to the application deadline must be repeated or the student may demonstrate competency through the National League for Nursing (NLN) exam. This exam may only be taken once and if the student does not pass on the first attempt the courses will have to be repeated. Contact the Testing Center for information about the examination.
2. Requirements to be completed after initial acceptance and before the start of the program include:
 - a. Complete the prerequisite courses of **BIOL 2401**, **BIOL 2402**, **PSYC 2301**, and **ENGL 1301**.
 - b. Complete two criminal background checks. A social security number is required and will be verified during the background checks. The first is a DPS/FBI background check that the Texas Board of Nursing requires on all accepted nursing students. The second background check is done by a private firm and is required by clinical affiliates. A satisfactory criminal background check as determined by the requirements of the Texas BON and clinical affiliates is required for final admission into the ADN program. See ADN application packet for further information about BON background check procedures. Individuals with felonies are ineligible for admission. A person with a criminal history other than a felony may be eligible to be considered for admission if:
 - i. The Texas Board of Nursing indicates in a letter that a petition for "Declaratory Order" (DO) was received and the individual is eligible to apply to take the licensure examination. The BON website, www.bon.texas.gov, contains eligibility questions and the link to the Nurse Portal to submit the DO. And,
 - ii. The ADN clinical affiliates permit the person to practice in their agency.
 - c. CPR Certification from American Heart Association: Basic Life Support (BLS) for Health Care Providers.
 - d. Physical examination. Form provided by the department.

- e. Up-to-date immunizations as required by the Texas Department of Health and clinical affiliates (measles, mumps, rubella, tetanus, diphtheria, pertussis, varicella, hepatitis "B" series of 3 immunizations, seasonal flu; positive titer is required for hepatitis B following semester 1 and others as required by clinical affiliates).
 - f. Negative tuberculin screen (yearly) [Initial testing must be a 2-step skin test or Quantiferon Gold blood test.]
 - g. Negative drug test.
 - h. Purchase of a school uniform and lab supplies.
 - i. Health insurance is required beginning the 2nd semester for Traditional students and the 1st semester for Transition students.
3. Each student is required to pay for standardized, computerized exams administered throughout the program, as well as testing software used to administer unit and final exams.
 4. Students attend various clinical sites in the Houston/Galveston region throughout the program. Clinical times/days vary each semester and include weekend and evening hours.
 5. Statutory law (Texas Occupations Code, Chapter 53) requires the Alvin Community College nursing and allied health programs to notify prospective applicants and future healthcare professionals a licensing/credentialing authority may suspend or revoke a license/credential, disqualify a person from receiving a license/credential, or deny to a person the opportunity to take a licensing/credentialing examination on the grounds that the person has been convicted of certain criminal behavior.

Transfer of Nursing Credits:

1. Courses accepted for transfer must be similar in content and credit to the ACC course(s).
2. No grade below a "B" in any (RNSG) nursing course is accepted for transfer.
3. Transfer applicants who, in the last 2 years, were enrolled in a professional nursing program and attempted/completed nursing course(s) with clinical component(s), are considered for admission on a space available basis. Applicants must:
 - a. Apply and meet the criteria for admission to the ADN program at ACC during an application period.
 - b. Have a written recommendation from the Dean/Director of their previous nursing program.
 - c. Demonstrate competency in previously completed nursing courses prior to admission through our Prior Learning Assessment process. Applicants will take a written departmental examination and a clinical skills competency demonstration to be awarded transfer credit. The tests will be administered once per semester and evaluated by a faculty review committee. Contact the department for test dates.

Progression / Dismissal Policies:

1. Students will abide by the current ADN admission, curriculum, and program requirements at the time they are admitted to the Associate Degree Nursing Program.
2. Once a student has enrolled in the ADN Program, all nursing courses and related courses must be completed in proper sequence as shown in the catalog and degree plan. The program must be completed within three (3) years of the initial acceptance.
3. No grade below a C in nursing curriculum science and nursing courses will be acceptable for progression.
4. In order to receive a grade of C, a minimum grade of 75% must be attained in each nursing course.
5. Once enrolled in the ADN program, it is expected that enrollment is continuous. Students with a break in enrollment must apply for readmission. A break in enrollment includes: 1) Receipt of a grade of D, F, or W in a nursing course requiring a repeat of the course, 2) Withdrawal from a nursing course with a clinical component, and/or 3) Non-enrollment in a nursing course for one (1) or more semesters (excluding summer).
6. A student who withdraws from a nursing course with a related clinical component must withdraw from the corresponding course.
7. A student who receives a grade of D or F in a nursing course with a related clinical component will be assigned the grade of "R" in the corresponding course. The student must, if eligible, re-enroll in both the theory and clinical sections of that course. Each semester's co-requisite RNSG courses must be completed with a minimum grade of C in order to progress.
8. A student must achieve an overall GPA of 2.0 in all courses in the nursing curriculum in order to progress to the next nursing course.
9. A student will be terminated from the ADN Program if he/she has received more than one (1) D or F in a nursing course. This includes courses which have been repeated and a passing grade (A, B, or C) received in a subsequent attempt, regardless of the college or university where the initial grade (D or F) was received.
10. Co-requisite courses must be completed for a student to progress to the next semester.
11. A student requiring hospitalization, has a serious illness, is pregnant, or sustains an injury will be required to obtain a written statement from his/her physician verifying the health status of the student is adequate for performance in class, lab, and in the clinical setting. A student may not be allowed to return to the clinical or lab area if he/she is unable to perform the required job functions or if he/she must be on medications which may interfere with his/her ability to perform satisfactorily.
12. Due to the physical nature of the profession, technical standards, and job requirements, there is no "light duty" in this program. If a student cannot perform the required duties for any reason, the student will be required to withdraw in good standing and return as soon as the student is cleared by his/her physician, when the course is offered again. A plan for completion will be established that meets the needs of the student and the college time line.

13. A student may be dismissed from the program for demonstration of unprofessional and unsafe behaviors as described in the Texas Administrative Code 215.8. When dismissed, a grade of "F" will be assigned to the RNSG course where the behavior occurred. A "W" will be assigned to any other RNSG courses taken concurrently.
14. A student may be dismissed from the program for academic dishonesty. When dismissed, a grade of "F" will be assigned to the RNSG course where the behavior occurred. A "W" will be assigned to any other RNSG courses taken concurrently.
15. Notification by the BON that a student has been involved in criminal activity may result in temporary withdrawal or termination from the ADN program.

Readmission: Students may be readmitted to the ADN Program ONCE after withdrawal or failure of a course.

1. Once enrolled in the ADN program, a student who receives a D, F, or W in a nursing course or drops a nursing course, must, if eligible apply for readmission.
2. Students are readmitted on a space available basis and on the student's compliance with conditions/requirements established by the Director. These requirements may include remediation in academic course work, repeat of nursing course(s) previously taken, or documentation of recovery from illness. Inability to meet the readmission stipulations may be grounds for denial or permanent dismissal from the program.
3. Students applying for readmission must apply in writing to the Director at least 14 days prior to the semester in which readmission is desired. Include the following information: Date of withdrawal from the Program; primary reason(s) for withdrawal from the Program; understanding of the requirements for readmission at the time of withdrawal; ways in which recommendations at the time of withdrawal have been completed; and what has been done to improve chances for successful completion.
4. A student who has withdrawn from the ADN program during the first semester must reapply during the program application period and be ranked with that applicant pool.
5. Evidence of competency in previously completed nursing courses will be required prior to readmission. This will be accomplished through an examination and a clinical skills competency demonstration. Tests will be administered once per semester and evaluated by a faculty review committee. Contact the Director for test dates.
6. Re-entering students must abide by the current admission, curriculum and program requirements of the department.
7. Following a second withdrawal from the program, a student will not be readmitted. Students may petition for re-admission when a withdrawal occurs because of a catastrophic event. The student must have had a passing grade in the RNSG course at the time of withdrawal. Petition will be considered by a faculty review committee.
8. The department reserves the right to deny readmission to a student who discontinued the program due to academic dishonesty or exhibited unsafe and/or unprofessional behavior. The decision to deny or accept readmission will be made by a faculty review committee.
9. Students who are unsuccessful in a professional nursing program and subsequently complete a vocational nursing program are eligible to apply to the LVN-ADN Transition track. Eligibility penalties for the "D's, F's or W's" earned in nursing courses while previously enrolled in the professional nursing program are eliminated for these students. Grades of "D" or "F" still apply for BIOL.
10. All courses must be completed within three (3) years of original enrollment date into the ADN program.

The following courses have been adopted by THECB as part of a Field of Study Curriculum in Nursing: BIOL 2401, BIOL 2402, BIOL 2420, PSYC 2301, PSYC 2314, MATH 1342, ENGL 1301, ENGL 1302, and BIOL 1322/HECO 1322. The Nursing FOS is intended for the generic baccalaureate degree seeking student.

For individual course descriptions, please refer to the College Catalog at <https://www.alvincollege.edu/catalog/index.html>

Prerequisites

-
- BIOL 2401 - Anatomy and Physiology I 4 Course Credits ^{Δ +}
 - BIOL 2402 - Anatomy and Physiology II 4 Course Credits ^{Δ +}
 - ENGL 1301 - Composition I 3 Course Credits ^{Δ +}
 - PSYC 2301 - General Psychology 3 Course Credits ^{Δ +}

Semester Credits: 14

First Year

First Semester

- PSYC 2314 - Lifespan Growth and Development 3 Course Credits ^{Δ**}
- RNSG 1219 - Integrated Nursing Skills I 2 Course Credits
- RNSG 1260 - Clinical RN I 2 Course Credits
- RNSG 1523 - Intro to Prof Nur for Integrated Program 5 Course Credits

Semester Credits: 12

Second Semester

- BIOL 2420 - Microbiology for Non-Science Majors 4 Course Credits ^Δ **
- RNSG 1129 - Integrated Nursing Skills II 1 Course Credits
- RNSG 1461 - Clinical II RN 4 Course Credits
- RNSG 2504 - Integrated Care - Common Needs 5 Course Credits

Semester Credits: 14

Second Year

First Semester

- Select 3 Course Credits from Creative Arts Core Curriculum **+ **REQUIRED ELECTIVE COURSE: Take ONE course from the list at the end of this packet.**
- or
- Select 3 Course Credits from Language, Philosophy and Culture Core Curriculum **+
- RNSG 2462 - Clinical III RN 4 Course Credits
- RNSG 2514 - Integrated Care - Complex Needs 5 Course Credits

Semester Credits: 12

Second Semester

- RNSG 2435 - Integrated Care - Management 4 Course Credits
- RNSG 2463 - Clinical-RN IV 4 Course Credits *

Semester Credits: 8

Total Credits Required for A.A.S. Nursing: 60

(+) Denotes core requirement. Speak with Department Chair or Pathways Advisor for proper course selection.

* Capstone Course

^Δ Field of Study Curriculum course.

** May be taken prior to admission to the ADN program.

Priority admission for applicants who:

1. achieved high standardized test scores, and
2. earned a high grade point average in the ADN curriculum academic coursework.

+If you have grades in any of these courses at the time you apply, the GPA of those grades must be at least 3.0. Courses in-progress at the time you apply, grades posted after the nursing deadline, and/or grades that are not part of the ADN degree do NOT count in the GPA. See "How do I calculate my GPA" in the Frequently Asked Questions at the end of this document to find out whether your GPA is high enough.

Statutory law (Texas Occupations Code, Chapter 53) requires the Alvin Community College nursing and allied health programs to notify prospective applicants and future healthcare professionals a licensing/credentialing authority may suspend or revoke a license/ credential, disqualify a person from receiving a license/credential, or deny to a person the opportunity to take a licensing/credentialing examination on the grounds that the person has been convicted of certain criminal behavior.

BACKGROUND CHECKS

Two clear background checks are required **as a condition of full acceptance** after initial acceptance into an ACC nursing program and before you may enroll in any nursing course that has a clinical component: (1) a DPS/FBI background check conducted by the Texas Board of Nursing (BON); and (2) a background check by Viewpoint which is required by clinical affiliates.

A Petition for Declaratory Order (DO) is a formal disclosure to the Board of Nursing of an eligibility issue that may prevent an applicant from taking the NCLEX and receiving initial licensure. **The DO permits the Board to make a decision regarding a petitioner's eligibility for licensure prior to entering or completing a nursing program.**

A Petition for DO should only be submitted after receiving an outcome letter requesting it, or if you received a Blue Card, BUT have to disclose a non-CBC related eligibility issue (i.e. answering "yes" to any questions other than Question 4).

You should submit the DO & \$150 if:

- You submitted fingerprints as part of the New/Accepted Student Roster process & you received an outcome letter from the Board requesting the submission of the DO & \$150.

You should submit the DO ONLY if:

- You submitted fingerprints as part of the New/Accepted Student Roster process & received a Blue Card, **BUT** have to disclose a non-CBC related eligibility issue (i.e. answering "yes" to any question other than Question 4 on the following license eligibility questions).

You will need to contact the Board for specific instructions on submitting the DO without the \$150 payment. Please send an email with your name, DOB, and last 4 of your SSN to webmaster@bon.texas.gov. The subject line should be DO – Payment Bypass.

The Petition for DO must be submitted electronically via the Nurse Portal (<https://www.bon.texas.gov/texasnurseportal/>).

If you submit a Petition, the BON will investigate your case and then send you a letter stating whether you are eligible to sit for the NCLEX licensure exam. If the BON letter says you are eligible to sit for the licensure exam, you must submit the letter to the nursing department no later than 30 days before first day of class. If you do not have the BON letter by 30 days before first day of class, you will not be eligible to enroll in the nursing program, and you will have to re-apply to the next nursing program after you do receive the BON letter.

You are eligible for admission into an ACC nursing program only after you: (1) Submit the Petition for Declaratory Order form to the BON; (2) Receive the BON outcome letter verifying your eligibility for future licensure; (3) Submit the BON outcome letter to the nursing department no later than 30 days before first day of class; and (4) meet the minimum standards set by clinical affiliates.

If you know you have an issue that will require disclosure, you may begin gathering necessary documentation and writing a letter of explanation. However, you should wait for the outcome letter requesting the Petition for DO, or a Blue Card, IF you have to disclose a non-CBC related eligibility issue (i.e. answering "yes" to any question other than Question 4 on the following license eligibility questions).

Satisfactory criminal background check findings are determined by the licensure eligibility criteria established by the BON and standards mandated by clinical affiliates and ADN program policy.

Applicants who are convicted of a felony, appealing a felony conviction, have a deferred adjudication felony, or are on parole for a felony, are not eligible for admission to Alvin Community College nursing programs. "Conviction" is defined in [Texas Administrative Code Chapter 213, RULE §213.1, #12](#)

This policy is applicable even if a prospective student has filed a "Petition for Declaratory Order" with the BON and received BON consent to sit for the NCLEX-RN after graduation from an approved ADN program.

Texas Board of Nursing (BON) Licensure Eligibility Questions

1. Have you ever had any disciplinary action on a nursing license or a privilege to practice in any state, country, or province?
2. Do you have an investigation or complaint pending on a nursing license or a privilege to practice in any state, country, or province?
3. Have you, in the last 5 years*, been addicted to and/or treated for the use of alcohol or any other drug?
4. For any criminal offense*, including those pending appeal, have you:
(You may only exclude Class C misdemeanor traffic violations or offenses previously disclosed to the Texas Board of Nursing on an initial or renewal application.)
 - A. been arrested and have a pending criminal charge?
 - B. been convicted of a misdemeanor?
 - C. been convicted of a felony?
 - D. pled nolo contendere, no contest, or guilty?
 - E. received deferred adjudication?
 - F. been placed on community supervision or court-ordered probation, whether or not adjudicated guilty?
 - G. been sentenced to serve jail, prison time, or court-ordered confinement?
 - H. been granted pre-trial diversion?
 - I. been cited or charged with any violation of the law?
 - J. been subject of a court-martial; Article 15 violation; or received any form of military judgment/punishment/action?

NOTE: Expunged and Sealed Offenses: While expunged or sealed offense, arrests, tickets, or citations need not be disclosed, it is your responsibility to ensure the offense, arrest, ticket or citation has, in fact, been expunged or sealed. It is recommended that you submit a copy of the Court Order expunging or sealing the record in question to our office with your application. Non-disclosure of relevant offenses raises questions related to truthfulness and character. (See 22 TAC §213.27)

NOTE: Orders of Non-Disclosure: Pursuant to Tex. Gov't Code § 552.142(b), if you have criminal matters that are the subject of an order of non-disclosure you are not required to reveal those criminal matters. However, a criminal matter that is the subject of an order of non-disclosure may become a character and fitness issue. Pursuant to Gov't Code chapter 411, the Texas Nursing Board is entitled to access criminal history record information that is the subject of an order of non-disclosure. If the Board discovers a criminal matter that is the subject of an order of non-disclosure, even if you properly did not reveal that matter, the Board may require you to provide information about any conduct that raises issues of character and fitness.

5. Have you ever had any licensing (other than a nursing license) or regulatory authority in any state, jurisdiction, country, or province revoked, annulled, cancelled, accepted surrender of, suspended, placed on probation, refused to renew or otherwise discipline any other professional or occupational license, certificate, nurse aide registration or multistate privilege to practice that you held?
6. Are you currently suffering from any condition for which you are not being appropriately treated that impairs your judgment or that would otherwise adversely affect your ability to practice nursing in a competent, ethical, and professional manner?
7. *Are you currently the target or subject of a grand jury or governmental agency investigation?
8. *Are you currently a participant in an alternative to discipline, diversion, or a peer assistance program? (This includes all confidential programs)

NOTE: Any positive response will remain confidential and not subject to public disclosure unless required by law.

9. Have you ever been granted the authority to practice nursing in any country, state, province, or territory?

NOTE: This does not apply to any nursing license(s) issued by another US state or territory, excluding Puerto Rico. If you were licensed in Puerto Rico, you should be answering yes.

*Pursuant to the Texas Occupations Code §301.207, information, including diagnosis and treatment, regarding an individual's physical or mental condition, intemperate use of drugs or alcohol, or chemical dependency and information regarding an individual's criminal history is confidential to the same extent that information collected as part of an investigation is confidential under the Texas Occupations Code §301.466.

ALVIN COMMUNITY COLLEGE

APPROXIMATE COST for LVN-to-ADN TRANSITION PROGRAM

Semester	RNSG Credit Hours	ACC Tuition			ACC Fees	Course Fees	Required Texts	Additional Expenses <i>see below</i>	TOTALS		
		In-district	Out-of-district	Out-of-state					In-district	Out-of-district	Out-of-state
FIRST	7	357	714	1085	291	828	573	780	2,829	3,186	3,557
SECOND	9	459	918	1395	311	459		0	1,229	1,688	2,165
THIRD	8	408	816	1240	301	459	85	819	2,072	2,480	2,904
TOTAL	24	\$1,224	\$2,448	\$3,720	\$903	\$1,746	\$658	\$1,599	\$6,130	\$7,354	\$8,626

Costs are approximate and subject to change without notice.

Costs for nursing courses only (courses starting with "RNSG"); non-nursing courses are extra

Approximate costs for required nursing texts only; optional nursing texts are extra

ADDITIONAL EXPENSES

1st Semester	
Uniform+shoes (varies by size and gender)	175
Nurse Pack	140
Supplies-(Stethoscope, Scissors, etc.)	96
ANSA dues	10
Criminal Background Check + Drug Screen	95
Criminal Background Check - BON DPS/FBI	40
CPR certification	100
HESI-A2 test fee	74
Hepatitis B titer	50
Apple iPad, Kindle, or Tablet	varies
Physical exam, TB test, immunizations	varies
Health Insurance	varies
Subtotal	\$780

2nd Semester	
Subtotal	\$0

Last Semester	
Licensure Application fee - Texas BON	100
NCLEX-RN Registration	200
NCLEX-RN Review Course (recommended)	400
Pictures for Licensure	27
Associate Degree Nursing Pin	40
Lamp for Pinning Ceremony	15
Graduation Cap and Gown	37
Subtotal	\$819

Alvin Community College may change tuition rates and other fees without notice or when directed to do so by the ACC Board of Regents.

Please contact the college business office if you need an exact cost listing for financial aid purposes.

Check with your health care provider regarding costs of physical exam, TB screen & immunizations

Transportation costs and parking fees at clinical sites vary depending on clinical sites attended

**ALVIN COMMUNITY COLLEGE
ASSOCIATE DEGREE NURSING 2-year PROGRAM
FREQUENTLY ASKED QUESTIONS**

1. **How do I get an Associate Degree Nursing (ADN) application?** There is no paper application form; you must apply online at the ADN web page: <http://www.alvincollege.edu/ADN/application>. Please see the ADN web page for application dates. You must be admitted to ACC before you can apply to ADN. If you are not already admitted to ACC, apply to ACC at: <https://www.alvincollege.edu/admissions/getting-started-first-time-students.html>
2. **When does the program begin?** 2-year ADN programs begin every August and January. One-year LVN-to-ADN Transition program begins every June (summer semester).
3. **What are the requirements for admission?** Please see the ADN admission requirements in the current ACC catalog and ADN application instructions. All ADN applicants must meet minimum admission requirements for both the COLLEGE and the ADN PROGRAM to be eligible for consideration for acceptance into an ADN program.
4. **What are the prerequisite courses?** The 2-year program prereqs are BIOL-2401, BIOL-2402, ENGL-1301 and PSYC 2301. The Transition prereqs are BIOL-2401, BIOL-2402, BIOL-2420, ENGL-1301, PSYC-2301 and PSYC-2314. You may apply to a nursing program while "in progress" in prereqs, but if you are accepted into a nursing program, you must have passing grades in all the prereqs before the nursing program starts. Any "in progress" prereq courses are not counted in your GPA when ranking you against other applicants.
5. **What admission test is used for nursing?** All ADN applicants must take the HESI A2 entrance exam, which is mandatory regardless of educational background - no exceptions. Acceptable HESI A2 scores must be submitted to the ADN department by the ADN application deadline. Required minimum scores: at least 78 on the composite score and at least 78 on the reading section. All of these sections must be taken: Math, Reading Comprehension, Vocabulary and General Knowledge, Grammar, and Anatomy and Physiology. The HESI A2 must be taken within 5 years of the ADN application deadline. We do not accept HESI score reports from applicants. See the ADN application instructions for more details on the HESI exam.
6. **How are students selected for admission?** Admission is competitive. After the application deadline, applicants are ranked primarily according to the number of completed courses in the ADN curriculum, the GPA of those courses (GPA must be at least 3.0), and HESI A2 test scores (see minimum scores above). Priority admission is given to applicants who: 1) achieve high HESI A2 scores; 2) have a high grade point average in ADN curriculum academic coursework; and 3) completed BIOL 2420 and/or PSYC 2314. Additional consideration is given to applicants who: 1) complete ADN curriculum courses without repeating or withdrawing from courses in the last five years from the application deadline; 2) complete ADN curriculum courses at ACC; 3) hold a Bachelor's or higher degree from an accredited college or university; and, 4) reside in the ACC tax district.

To get a high ranking, you should have high grades in as many ADN curriculum courses as possible for a high GPA and achieve high HESI A2 scores. We do not count grades of courses that are not part of the ADN curriculum. Admission is very competitive, and students accepted into the program usually have completed many ADN curriculum courses with an A or B+ average and have HESI scores significantly higher than the required minimum scores.
7. **How do I calculate my GPA?** To find out whether your GPA meets the minimum requirement of 3.0, use a [GPA calculator](#). Put in grades for all the non-RNSG courses you have that are in our ADN degree plan. Allowed electives are in the box at the bottom of the "degree plan" page. If you have more than one elective, only put the highest grade you made in ONE elective. DO NOT put in grades for any other courses. For each course, put the letter grade in the left column and the course's number of credit hours in the right column. The GPA must be 3.0 or higher for you to be eligible to apply to the ADN program.
8. **What courses can I take before starting the ADN program?** You may take some or all of the general education (non-nursing) courses ahead of time, with the requirement that all prereqs must be completed before starting a nursing program. Applicants who complete many RNSG degree plan general education courses with a high GPA will rank higher in the admission process. Whatever grades you have in general education courses at the time you apply, the GPA of those grades must be at least 3.0. "In-progress" courses are not counted in your GPA in the ranking process.

9. **Will courses from other colleges transfer to the ACC ADN program?** Courses are eligible for transfer from regionally accredited colleges and universities when content and credit hours are equivalent to the courses in the ADN curriculum. Transferred general education (non-nursing) courses must have a grade of "C" or better. Transferred nursing courses must have a grade of "B" or better. Please see information in the "Transfer of Nursing Credits" section of the College Catalog for details on transferring nursing courses.
10. **Is there a time limit on courses?** BIOL A&P courses more than 5 years old as of the application deadline must be repeated, or successfully pass a competency exam. If you pass the competency exam(s), your old BIOL grade(s) will be used when ranking you against other applicants. Contact the Testing Center [281-756-3531](tel:281-756-3531) for information about competency exams. Please see information in the "Transfer of Nursing Credits" section of the College Catalog for details about time limits on nursing courses.
11. **How long does it take to finish the nursing program?** 2-year ADN: Once enrolled in the first nursing course, the ADN program takes 21 months during four long semesters (no summer RNSG courses). LVN-ADN Transition: Once enrolled in the first nursing course, the Transition Program takes one year.
12. **Can I work while I am in a nursing program?** The nursing program is very demanding in terms of time and effort. Depending on semester, classroom, lab and clinical hours will total 17-20 hours/week. In addition, students should budget at least three hours of outside study time for each hour spent in class. While many students are employed during their enrollment, a full-time work schedule of 40 hours/week is difficult to maintain. Work schedules must be planned around classroom and clinical requirements and must also be flexible since lecture and clinical hours may change from semester to semester.
13. **What are the days & hours of nursing classes?** Nursing classes are generally scheduled for four or five days per week: two to three short days and two long days. Nursing theory courses meet two-three days/week for 2-5 hours/day and are usually between the hours of 8 am and 3 pm. Clinical/lab days are 6 to 12 hours long and are held either in the campus skills lab or in a hospital or other clinical agency in the Houston/Galveston area. Clinical start/end times vary from semester to semester, but are usually between 6 am and 6 pm. Some clinical rotations will be during the evening or night shift and weekends.
14. **How much does the nursing program cost?** The approximate cost for tuition, fees, required textbooks and supplies for the entire 2-year program of nursing (RNSG) courses is approximately \$7,500 if you live in-district or \$9,500 if you live out of district (see cost breakdown page in the application packet). Approximate cost for the one-year LVN-ADN Transition program is \$6,100 if you live in-district and \$7,400 if you live out of district. Costs for non-RNSG courses in the ADN degree are extra. Costs for the following items are also extra: physical exam, tuberculosis test, immunizations, health insurance, a smart device (tablet or smart phone), and optional textbooks. These extra costs are too variable to include in the above estimates; you will need to estimate these extra costs yourself based on your personal situation. Alvin Community College may change tuition rates and other fees without notice or when so directed by the Board of Regents.
15. **What is the current job market for nurses?** Nursing is the largest health care occupation with more than 2 million jobs. According to government statistics, it is one of ten occupations projected to have the greatest number of new jobs.
16. **What is the salary potential for a new graduate nurse?** Earnings vary according to location and schedule worked. Starting salaries average just over \$50,000/year.
17. **Is financial aid available?** Students can apply for scholarships, grants and loans through the Admissions Office 281-756-3531. ACC Financial aid web page: <https://www.alvincollege.edu/financial-aid/index.html>
18. **What are the physical requirements to enter the nursing program?** The student must be in good health and not pose a threat to the health and safety of themselves or others. For more details, see section "ADA and Performance Requirements" in the *ADN Student Handbook* on the [ADN web page](#). After an applicant is accepted into the program, they must undergo a physical examination and submit a completed and signed "Statement of Fitness" form to the nursing office.

19. **Do I need to have health insurance?** Yes - clinical sites require students to have health insurance. Transition students are required to provide proof of coverage by the first class day of the summer session. The agencies do not specify the types of coverage or the extent of coverage you should buy, they just require you to be covered by a health insurance policy. Not having health insurance may prevent you from attending clinicals and prevent you from progressing in the nursing program.
20. **IMPORTANT – HEPATITIS B SHOTS:** You must turn in proof of at least your first two Hepatitis B shots or proof of Hep B immunity by the nursing application deadline. There is no time limit on Hepatitis B shots; childhood Hep B shot record is acceptable. There is a 5-year time limit on the Hep B immunity report. You will be told of other immunizations and medical tests to turn in only if you are accepted into a nursing program. 2-Year ADN students must submit a Hep B immunity report (called a Hep B titer) by the end of their first semester in the 2-year ADN program. Transition program students must submit a Hep B titer before beginning first semester classes.

Are there legal limitations for ADN program admission and licensure? Yes! If you have a history of criminal, psychiatric, or substance abuse events, the "Background Checks" page in the ADN application packet will tell you what to do. Applicants who are convicted of a felony, appealing a felony conviction, have a deferred adjudication felony, or on parole for a felony, are not eligible for admission to Alvin Community College nursing programs. "Conviction" is defined in [Texas Administrative Code Chapter 213, RULE §213.1, #12](#)

If you have further questions you are welcome to contact the ADN department
nursing@alvincollege.edu 281-756-5630

ELECTIVES - COURSE DESCRIPTIONS

The ADN degree requires ONE elective course which can be taken either before or during the nursing program. We will count the elective with the highest grade when ranking you during the nursing admission process. The elective must be on the list below.

If you do not see a course number on the list below matching an elective you already have, use the course descriptions as a guide. You may also call the Admissions department 281-756-3531 for assistance in determining whether your elective is on the list below.

Language, Philosophy & Culture

COMM 1307 - Introduction to Mass Communication (3 credits) - Survey of basic content and structural elements of mass media and their functions and influences on society. (3 lecture hours per week).

ENGL 2322 - British Literature I (3 credits) - A survey of the development of British literature from the Anglo-Saxon period to the Eighteenth Century. Students will study works of prose, poetry, drama, and fiction in relation to their historical, linguistic, and cultural contexts. Texts will be selected from a diverse group of authors and traditions. (3 lecture hours per week).

ENGL 2323 - British Literature II (3 credits) - A survey of the development of British literature from the Romantic period to the present. Students will study works of prose, poetry, drama, and fiction in relation to their historical and cultural contexts. Texts will be selected from a diverse group of authors and traditions. (3 lecture hours per week).

ENGL 2327 - American Literature I (3 credits) - A survey of American literature from the period of exploration and settlement through the Civil War. Students will study works of prose, poetry, drama, and fiction in relation to their historical and cultural contexts. Texts will be selected from among a diverse group of authors for what they reflect and reveal about the evolving American experience and character. (3 lecture hours per week)

ENGL 2328 - American Literature II (3 credits) - A survey of American literature from the Civil War to the present. Students will study works of prose, poetry, drama, and fiction in relation to their historical and cultural contexts. Texts will be selected from among a diverse group of authors for what they reflect and reveal about the evolving American experience and character. (3 lecture hours per week)

ENGL 2332 - World Literature I (3 credits) - A survey of world literature from the ancient world through the sixteenth century. Students will study works of prose, poetry, drama, and fiction in relation to their historical and cultural contexts. Texts will be selected from a diverse group of authors and traditions. (3 lecture hours per week).

ENGL 2333 - World Literature II (3 credits) - A survey of world literature from the seventeenth century to the present. Students will study works of prose, poetry, drama, and fiction in relation to their historical and cultural contexts. Texts will be selected from a diverse group of authors and traditions. (3 lecture hours per week).

FREN 2311 - Intermediate French I (3 credits) - This course provides a review and application of skills in listening comprehension, speaking, reading, and writing. It emphasizes conversation, vocabulary acquisition, reading, composition, and culture. (3 lecture and 1 lab hour per week)

FREN 2312 - French II (3 credits) - This course provides a review and application of skills in listening comprehension, speaking, reading, and writing. It emphasizes conversation, vocabulary acquisition, reading, composition, and culture. (3 lecture and 1 lab hour per week)

HUMA 1301 - Introduction to Humanities I (3 credits) - This stand-alone course is an interdisciplinary survey of cultures focusing on the philosophical and aesthetic factors in human values with an emphasis on the historical development of the individual and society and the need to create. (3 lecture hours per week).

HUMA 1302 - Introduction to Humanities II (3 credits) - This stand-alone course is an interdisciplinary survey of cultures focusing on the philosophical and aesthetic factors in human values with an emphasis on the historical development of the individual and society and the need to create. (3 lecture hours per week).

PHIL 1301 - Introduction to Philosophy (3 credits) - A study of major issues in philosophy and/or the work of major philosophical figures in philosophy. Topics in philosophy may include theories of reality, theories of knowledge, theories of value, and their practical applications. (3 lecture hours per week)

PHIL 1304 - Introduction to World Religions (3 credits) - A comparative study of world religions, including but not limited to Hinduism, Buddhism, Judaism, Christianity, and Islam, Sikhism, Jainism, and Shinto. (3 lecture hours per week)

PHIL 2306 - Introduction to Ethics (3 credits) - The systematic evaluation of classical and/or contemporary ethical theories concerning the good life, human conduct in society, morals, and standards of value. (3 lecture hours per week)

SPAN 2311 - Intermediate Spanish I (3 credits) - This course consolidates skills acquired at the introductory (beginning) level. It provides further development of proficiency in listening, speaking, reading and writing. It emphasizes comprehension, appreciation, and interpretation of the cultures of the Spanish-speaking world. (3 lecture and 1 lab hour per week).

SPAN 2312 - Intermediate Spanish II (3 credits) - This course continues the consolidation of skills acquired at the introductory (beginning) level. It provides further development of proficiency in listening, speaking, reading and writing. It emphasizes comprehension, appreciation, and interpretation of the cultures of the Spanish speaking world. (3 lecture and 1 lab hours per week).

SPAN 2313 - Spanish for Native/Heritage Speakers I (3 credits) - This course builds upon existing oral proficiencies of heritage speakers of Spanish. Enhances proficiencies in the home - based language by developing a full range of registers including public speaking and formal written discourse. Emphasis on comprehension, appreciation, and interpretation of the cultures of the Spanish - speaking world. (3 lecture hours and 1 lab hour per week)

SPAN 2315 - Spanish for Native/Heritage Speakers II (3 credits) - This course builds upon existing oral proficiencies of heritage speakers of Spanish. It enhances proficiencies in the home - based language by developing a full range of registers including public speaking and formal

written discourse. It emphasizes comprehension, appreciation, and interpretation of the cultures of the Spanish-speaking world. (3 lecture hours and 1 lab hour per week).

Creative Arts

ARTS 1301 - Art Appreciation (3 credits) - A general introduction to the visual arts designed to create an appreciation of the vocabulary, media, techniques, and purposes of the creative process. (3 lecture hours per week).

ARTS 1303 - Art History I (3 credits) - A chronological analysis of the historical and cultural contexts of the visual arts from prehistoric times to the 14th century. (3 lecture hours per week).

ARTS 1304 - Art History II (3 credits) - A chronological analysis of the historical and cultural contexts of the visual arts from the 14th century to the present day. (3 lecture hours per week).

COMM 2366 - Introduction to Cinema (3 credits) - Survey and analyze cinema including history, film techniques, production procedures, elected motion pictures, and cinema's impact on and reflection of society. (2 lecture and 4 lab hours per week).

DRAM 1310 - Introduction to Theater (3 credits) - Survey of theater including its history, dramatic works, stage techniques, production procedures, and relation to other art forms. Participation in productions may be required. (3 lecture and 2 lab hours per week).

DRAM 2362 - History of the Theater II (3 credits) - Study of the history of the theater from the Renaissance through today. (3 lecture hours per week).

DRAM 2366 - Introduction to Cinema (3 credits) - Survey and analyze cinema including history, film techniques, production procedures, selected motion pictures, and cinema's impact on and reflection of society. (2 lecture and 4 lab hours per week).

MUSI 1306 - Music Appreciation (3 credits) - Understanding music through the study of cultural periods, major composers, and musical elements. Illustrated with audio recordings and live performances. (Does not apply to a music major degree.) (3 lecture hours per week).

MUSI 1307 - Music Literature (3 credits) - A survey of the styles and forms of music as it developed from the middle ages to the present. This course will familiarize the student with cultural context, terminology, genres, and notation. (3 lecture hours per week).

MUSI 1310 - American Music (3 credits) - General survey of various styles of music in America. Topics may include jazz, ragtime, folk, rock, and contemporary art music. (3 lecture hours per week).

MAPS

How to Reach Alvin Community College

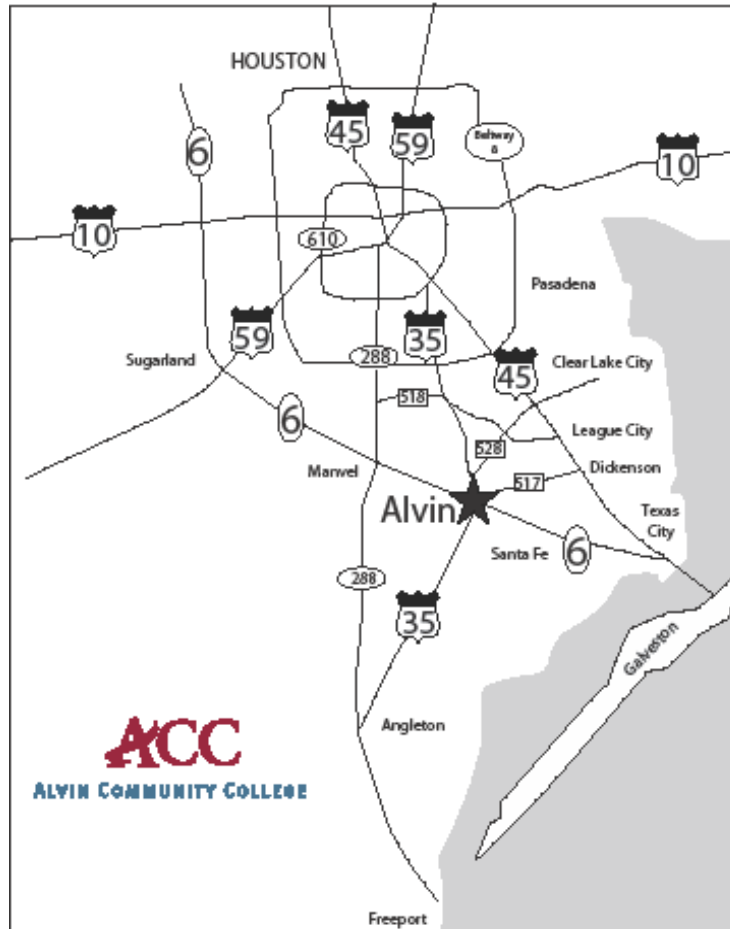

Alvin Community College is located 25 miles South of Houston and 30 miles North of Galveston on Hwy. 35 Bypass in Alvin, Texas.

From Houston, use Hwy. 35 South; or take I-45 South to Webster, then West on FM 528 to 35 Bypass; or Hwy 288 South to Manvel, then East on Hwy. 6 to 35 Bypass.

From Galveston, use Hwy. 6 to reach 35 Bypass, from Angleton and points South, use Hwy. 35.

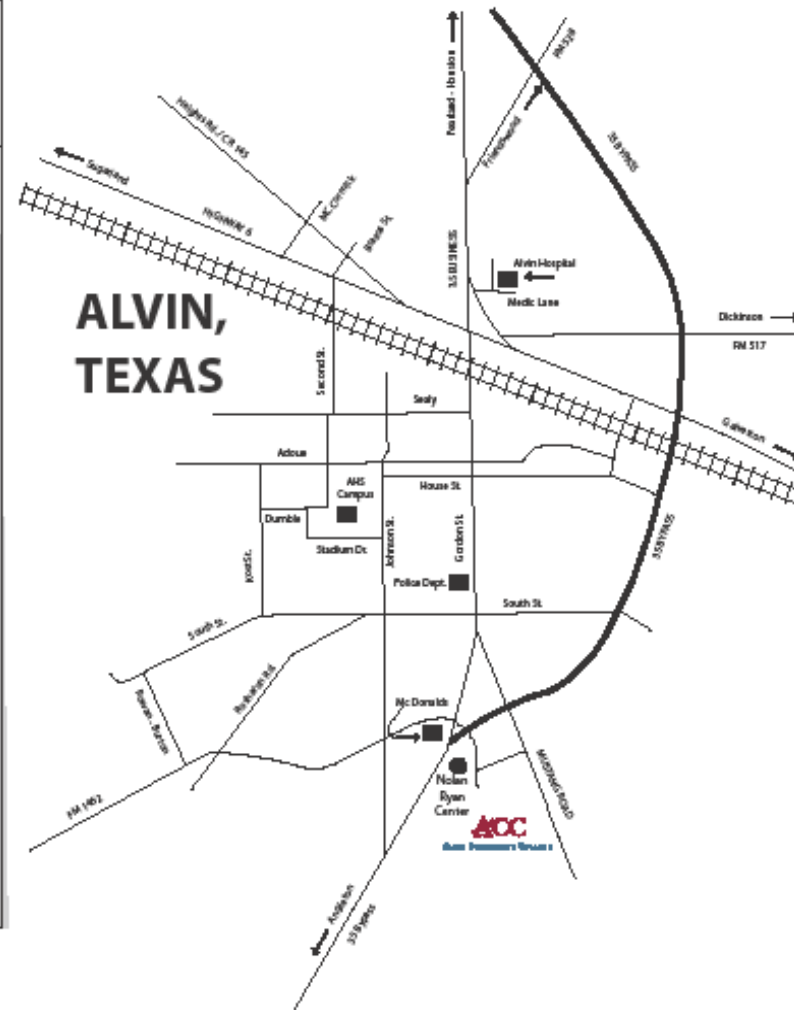

Alvin Community College Campus Map
 3110 Mustang Road
 Alvin, Texas 77511
 Main number: 281-756-3500
 ADN Office: Room S-108 281-756-5630
nursing@alvincollege.edu

ALVIN COMMUNITY COLLEGE CAMPUS MAP

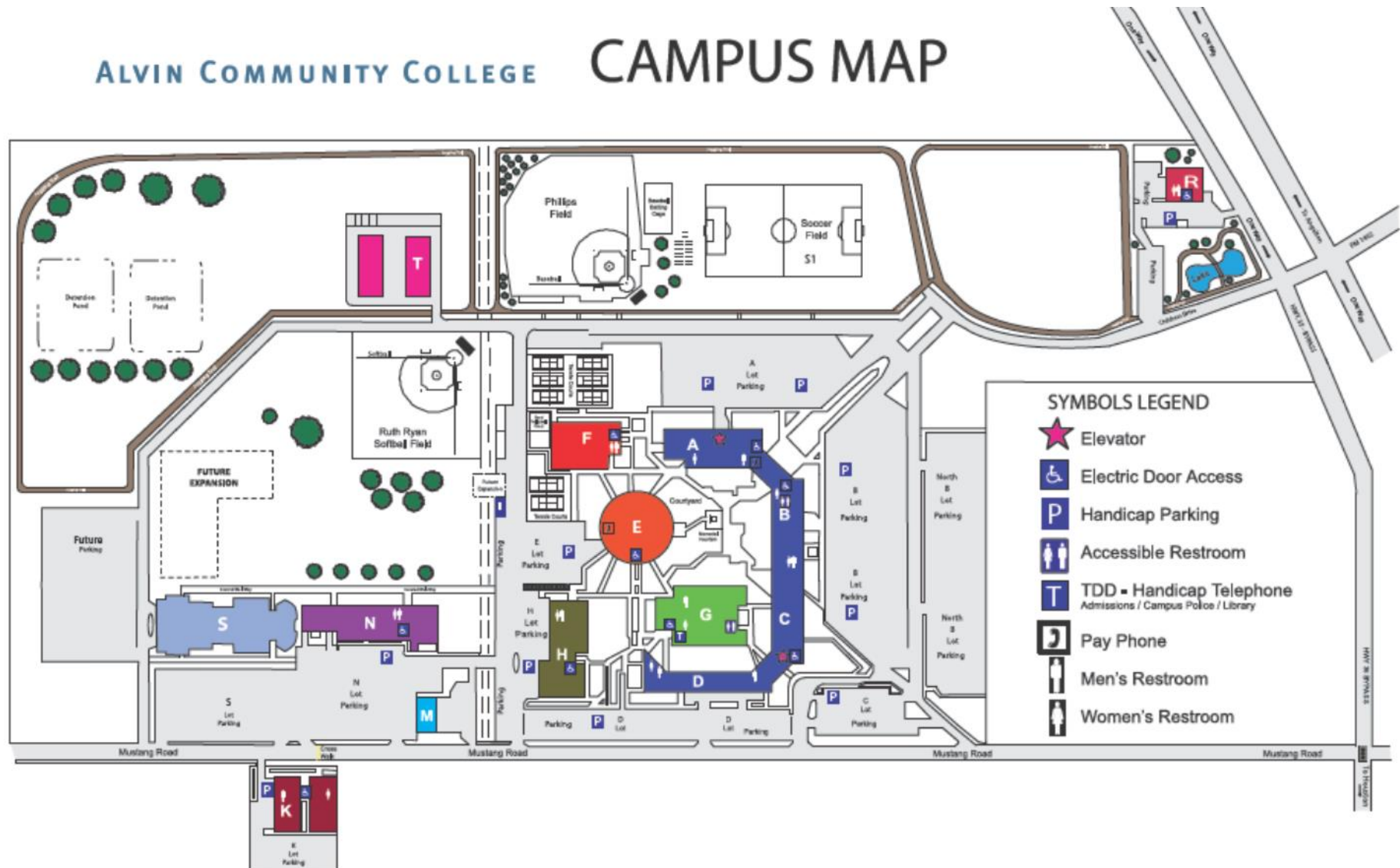

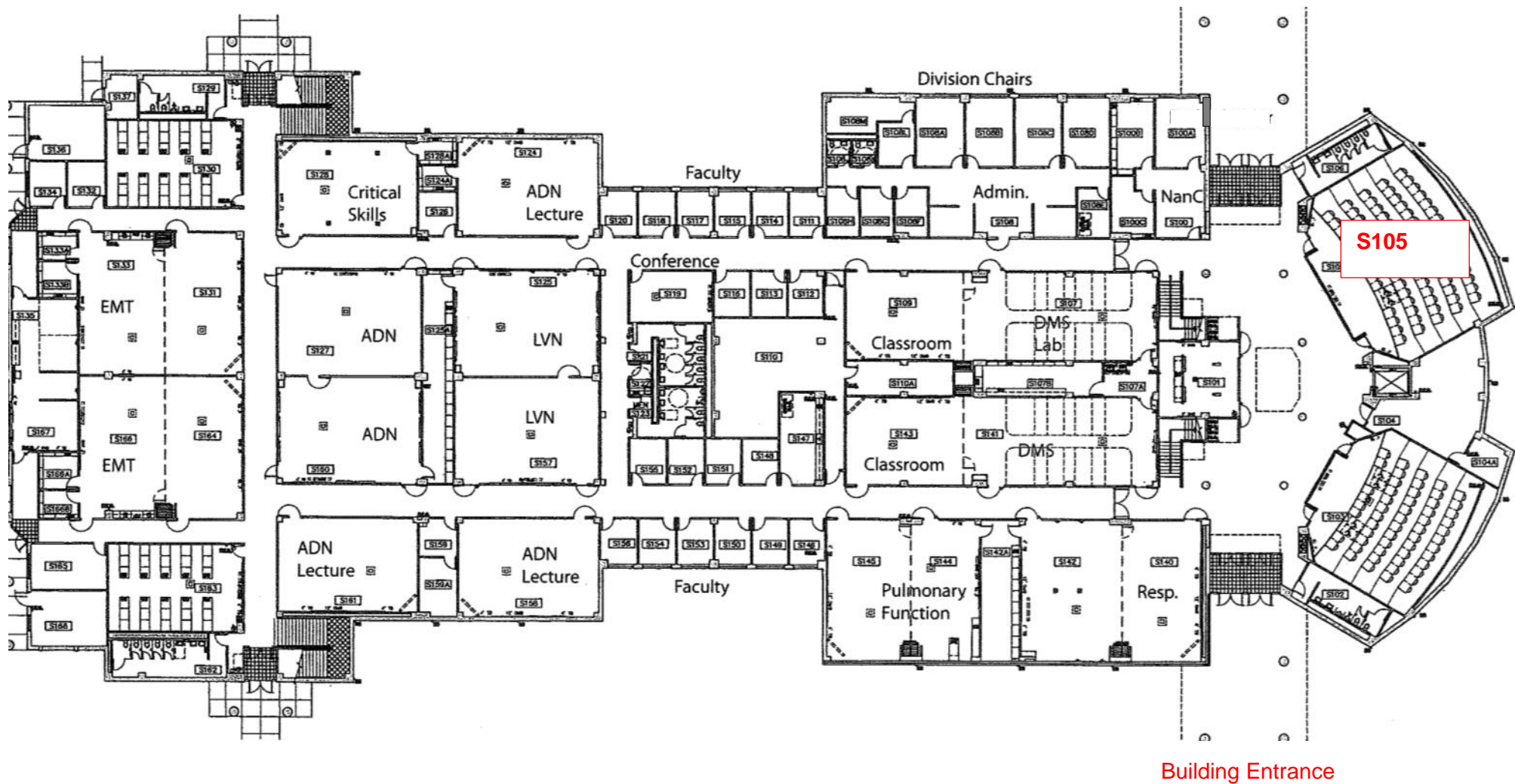

BUILDING S: Science / Health Science